

260FZ-KZ260

MONORACK SPECIFICO - SPECIFIC MONORACK  
MONORACK SPECIFIQUE - SPEZIFISCHES MONORACK - MONORACK ESPECÍFICO

# HONDA CBF500/600/1000

ISTRUZIONI DI MONTAGGIO - MOUNTING INSTRUCTIONS  
INSTRUCTIONS DE MONTAGE - BAUANLEITUNG - INSTRUCCIONES DE MONTAJE

1



MONORACK SPECIFICO  
SPECIFIC MONORACK  
MONORACK SPECIFIQUE  
SPEZIFISCHES MONORACK  
MONORACK ESPECÍFICO

Q.TY n.2(Dx-5x)

2



VITE TBEI M8x65mm  
SCREW M8x65mm  
VIS M8x65mm  
SCHRAUBE M8x65mm  
TORNILLO M8x65mm

Q.TY n.2

3

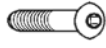

VITE TBEI M8x50mm  
SCREW M8x50mm  
VIS M8x50mm  
SCHRAUBE M8x50mm  
TORNILLO M8x50mm

Q.TY n.2

4



RONDELLA Ø8x14mm  
WASHER Ø8x14mm  
RONDELLE Ø8x14mm  
SCHEIBE Ø8x14mm  
ARANDELA Ø8x14mm

Q.TY n.4

5



DISTANZIALE 14x14mm  
foro 8,5mm  
SPACER  
ENTRETOISE  
Distanzstueck  
DISTANCIADOR

Q.TY n.2

6



DISTANZIALE 18x22mm  
foro 8,5mm Nero  
SPACER  
ENTRETOISE  
Distanzstueck  
DISTANCIADOR

Q.TY n.2

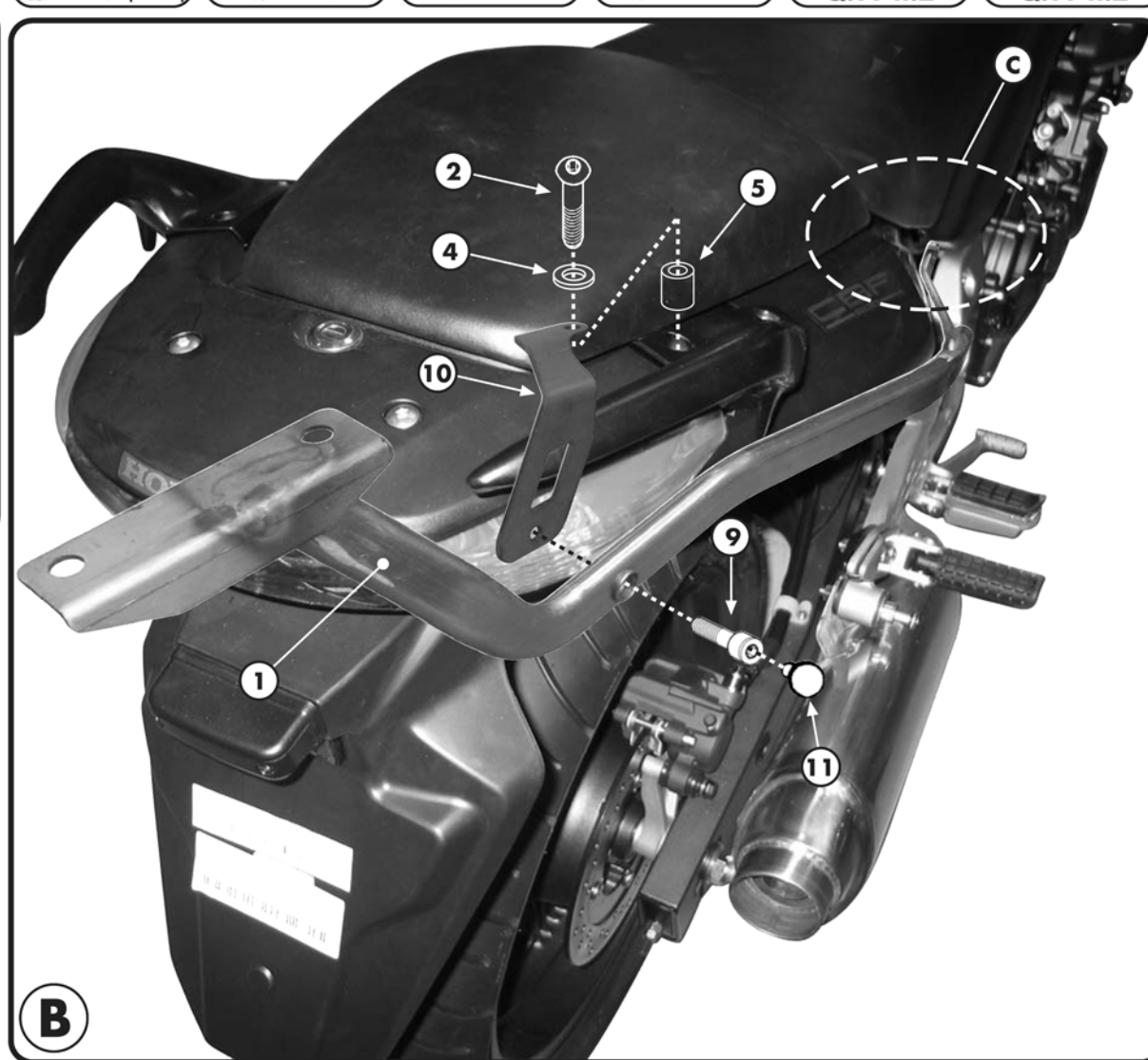
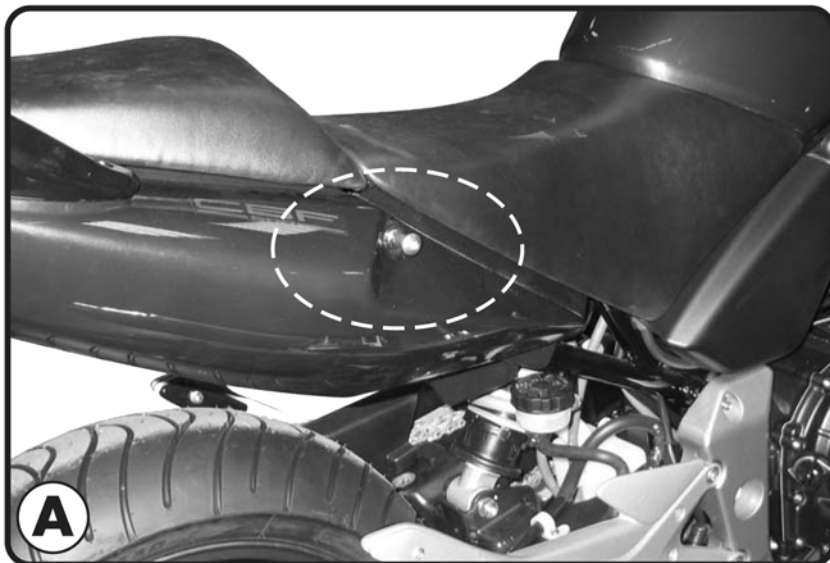

260FZ-KZ260

MONORACK SPECIFICO - SPECIFIC MONORACK  
 MONORACK SPECIFIQUE - SPEZIFISCHES MONORACK - MONORACK ESPECÍFICO

# HONDA CBF500/600/1000

ISTRUZIONI DI MONTAGGIO - MOUNTING INSTRUCTIONS  
 INSTRUCCIONES DE MONTAJE - BAUANLEITUNG - INSTRUCCIONES DE MONTAJE

7

**PARTICOLARI INCLUSI NEL KIT VITERIA DELLA PIASTRA**  
 COMPONENTS INCLUDED IN THE FITTING KIT OF THE PLATE  
 PIÈCES INCLUSES DANS LE KIT DE VIS DE LA PLATINE  
 DIE EINZELNEN TEILE SIND BEI MONTAGEKIT DER PLATTE ENTHALTEN  
 PIEZAS INCLUIDAS EN EL KIT DE TORNILLERÍA DE LA PARRILLA

**Q.TY n.-**

8

**COMPONENTI ORIGINALI**  
 ORIGINAL PARTS  
 ORIGINAL BAUTEILE  
 PARTIES ORIGINALES  
 COMPONENTES ORIGINALES

**Q.TY n.-**

9

**VITE TCEI M8x20mm**  
 SCREW M8x20mm  
 VIS M8x20mm  
 SCHRAUBE M8x20mm  
 TORNILLO M8x20mm

**Q.TY n.2**

10

**SUPPORTO**  
 SUPPORT  
 SUPPORT  
 HALTERUNG  
 SOPORTE

**Q.TY n.2**

11

**COPRIVITE Ø8**  
 SCREW CAP  
 CACHE VIS  
 STOPSSCHRAUBE  
 TAPA TORNILLO

**Q.TY n.2**

12

**GOMMINO**  
 Z1822  
 RUBBER  
 CAOUTCHOUC  
 GUMMI  
 GOMA

**Q.TY n.4**

13



**RONDELLA IN GOMMA**  
 Z1823  
 RUBBER WASHER  
 RONDELLE EN GOMME  
 GUMMISCHLEIBE  
 ARANDELA DE GOMA

**Q.TY n.4**

14



**DISTANZIALE Ø11x11mm foro Ø6,5mm**  
 V687  
 SPACER  
 ENTRETROISE  
 DISTANZSTUECK  
 DISTANCIADOR

**Q.TY n. 4**

15



**RONDELLA Ø6x20mm**  
 WASHER  
 RONDELLE  
 GUMMISCHLEIBE  
 ARANDELA

**Q.TY n.4**

16



**VITE TCEI M6x35mm**  
 SCREW M6x35mm  
 VIS M6x35mm  
 SCHRAUBE M6x35mm  
 TORNILLO M6x35mm

**Q.TY n.4**

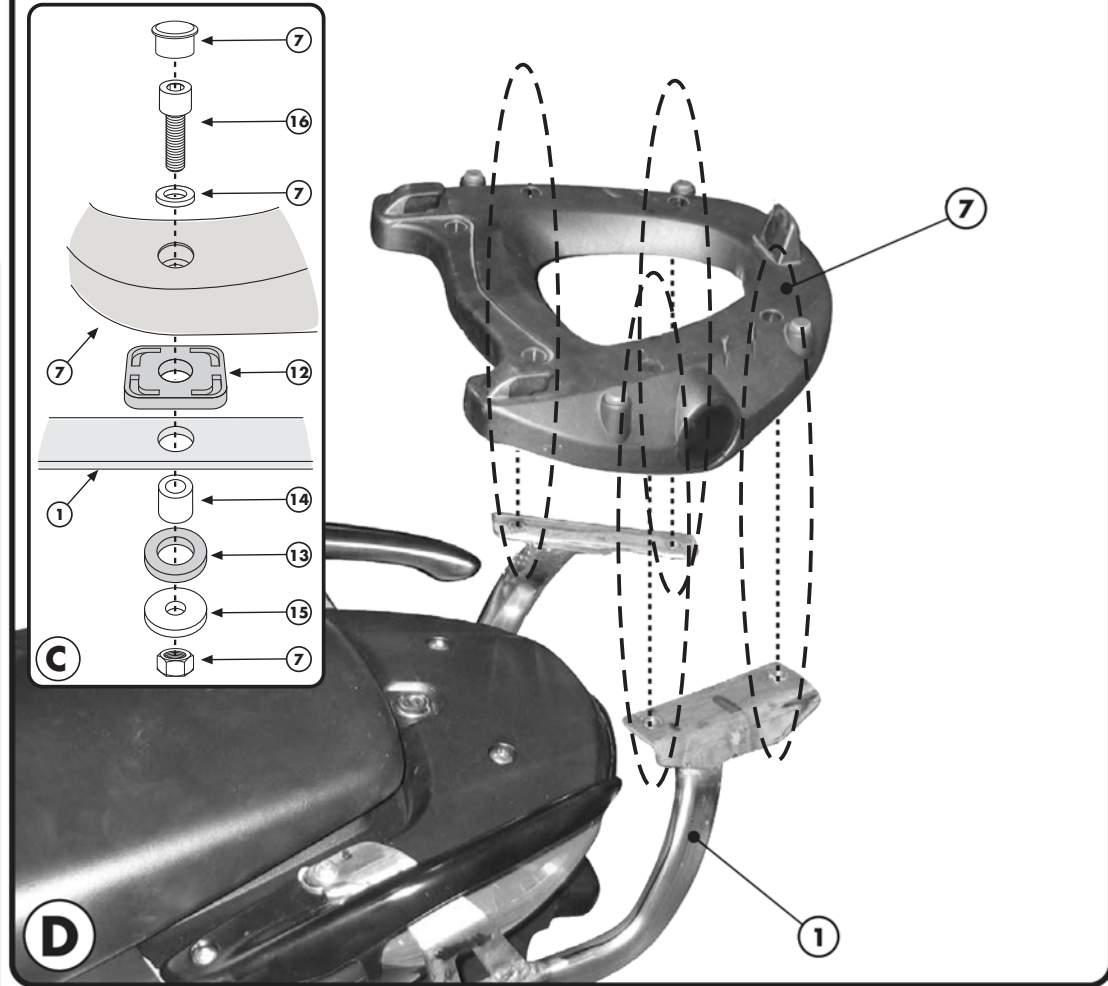
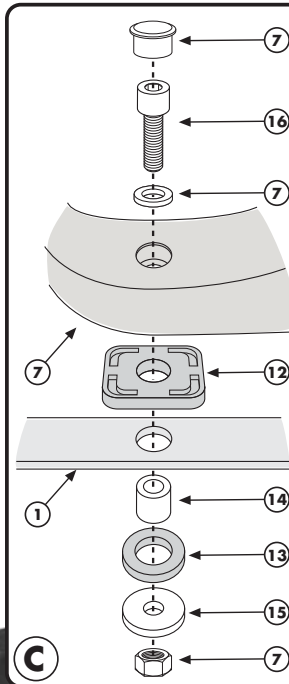
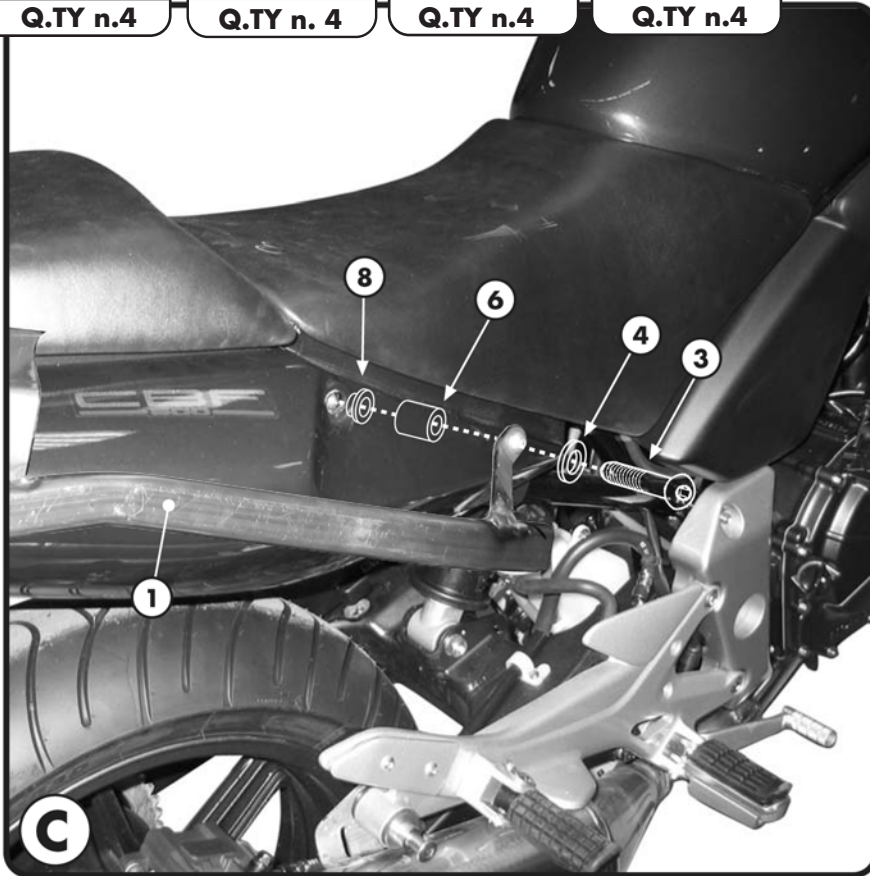

MONORACK SPECIFICO - SPECIFIC MONORACK  
MONORACK SPECIFIQUE - SPEZIFISCHES MONORACK - MONORACK ESPECÍFICO

# HONDA CBF500/600/1000

ISTRUZIONI DI MONTAGGIO - MOUNTING INSTRUCTIONS  
INSTRUCTIONS DE MONTAGE - BAUANLEITUNG - INSTRUCCIONES DE MONTAJE

## I ISTRUZIONI DI MONTAGGIO

1. SMONTARE IL NOTTOLINO ORIGINALE EVIDENZIATO IN FOTO A;
2. POSIZIONARE IL SUPPORTO MONORACK COME INDICATO IN FOTO B;
3. FISSARE LA PARTE ANTERIORE DEL SUPPORTO MONORACK COME INDICATO IN FOTO C;
4. MONTARE LA PIASTRA (NON INCLUSA) COME INDICATO IN FOTO D;
5. ULTIMARE IL MONTAGGIO SERRANDO BENE TUTTE LE VITI.

## GB MOUNTING INSTRUCTIONS

1. DEMOUNT THE ORIGINAL MUSHROOM INDICATED IN PICTURE A.
2. PLACE THE MONORACK ARM AS SHOWN IN PICTURE B;
3. FIX THE FRONT PART OF THE MONORACK AS SHOWN IN PICTURE C;
4. MOUNT THE PLATE (SOLD SEPARATELY) AS SHOWN IN PICTURE D;
5. LASTLY TIGHTEN ALL THE SCREWS.

## F INSTRUCTIONS DE MONTAGE

1. DEMONTER LES PLOTS D' ORIGINE MIS EN EVIDENCE SUR LA PHOTO A;
2. POSITIONNER LES BRAS DE MONORACK COMME INDIQUE SUR LA PHOTO B;
3. FIXER LA PARTIE AVANT DES SUPPORTS COMME INDIQUE SUR LA PHOTO C;
4. MONTER LA PLATINE (NON INCLUSE) COMME INDIQUE SUR LA PHOTO D;
5. TERMINER LE MONTAGE EN SERRANT BIEN TOUTES LES VIS.

## D BAUANLEITUNG

1. NEHMEN SIE DIE ORIGINAL KLINKE AB WIE IM BILD A ABGEBILDET;
2. POSITIONIEREN SIE DAS MONORACK WIE IM BILD B BESCHRIEBEN;
3. BEFESTIGEN SIE DAS VORDERTEIL DES MONORACKS WIE IM BILD C BESCHRIEBEN;
4. MONTIEREN SIE DIE PLATTE (NICHT VORHANDEN – SEPARAT BESTELLEN) WIE IM BILD D BESCHRIEBEN.
5. ZULETZT ZIEHEN SIE ALLE SCHRAUBEN FEST.

## ES

## INSTRUCCIONES DE MONTAJE

1. DESMONTAR EL REMACHE ORIGINAL INDICADO EN LA FOTO A;
2. MONTAR LOS BRAZOS MONORACK COMO INDICA LA FOTO B;
3. ANCLAR LA PARTE DELANTERA DEL BRAZO MONORACK COMO INDICA LA FOTO C;
4. MONTAR LA PARRILLA (NO INCLUIDA – SE VENDE POR SEPARADO) COMO INDICA LA FOTO D;
5. TERMINAR APRETANDO TODOS LOS TORNILLOS